

# OUTLAW COACH

2015 H-3 45' Quad SLIDE

VIN: 2018

## FACTORY-INSTALLED EQUIPMENT (Chassis)

Prevost-Patented Frameless Side Windows  
Dual Pane, Electrical Window Awnings  
Upper Side Window Front Cap  
Fog Lights  
Ramco® Remote Heated Rearview Mirrors:  
w/Separate Convex Top Painted  
Central Electrical Door Locking System  
Remote Keyless Locking Entrance Door  
Remote Keyless Locking Compartment Doors  
Trailer Hitch Package (20,000 lbs)  
Trailer Air Brake Connection  
Dual License Plate Holder  
Turn Signal Lights/Side Marker Lights (6)  
Cornering and Docking Lights  
Courtesy Lights Blinker Switch  
Compartment's and Engine Lighting  
ISRI Air Ride Driver Seat (6832)  
Exterior Graphic Design  
Back-Up Alarm  
Hot Water Booster Pump  
Headlamp Cleaning System

## GENERAL (Chassis)

Overall Length 45'  
Wheelbase 316.12"  
Overall Width 102"  
Overall Height 149"  
Floor-to-Ceiling Height (Finished) 79.5"  
Cabin Floor Height 63"  
Usable Cabin Flat Floor (Finished) 388sf  
Under-Floor Storage (w/Driver A/C) 497 cu ft  
Underfloor Compartment Doors Width 48.5"  
Entrance Door Width 27"  
Ground Clearance 11"  
Overhang (Incl. Bumper) - Front 75"  
Overhang (Incl. Bumper) - Rear 107"  
Turning Radius 42"  
State-of-the-art Soundproofing  
Fuel Tank (US Gal) 235  
Fuel Fill, Both sides  
Generator Hook-up on Main fuel Tank  
Electric Fuel Heater System  
Full Dash A/C, Condenser w/Copper Fins,  
Cooling Capacity 108,000 BTU/Hr  
A/C Refrigerant 134A  
Gross Vehicle Weight Rating (lbs) 55,500  
Wet Weight, w/Full A/C (lbs) 32,200  
Axle Design Load Capacity-Front (lbs) 19,000  
Axle Design Load Capacity-Drive (lbs) 22,500  
Axle Design Load Capacity-Tag (lbs) 14,000  
Roof Exhaust Extension 9"  
Body Construction Structure:  
Integral Stainless/Rust Protected Mild Steel  
Body Construction-Outer Shell :  
Up to Window Level, Fiber Composite  
Body Construction Sub-Frame:  
Low-Alloy/High Tensile Steel  
Insulated Baggage Bay Doors

## POWERTRAIN (Chassis)

EPA US10 compliant Volvo D13 Engine 500HP with Diesel  
Particulate Filter (DPF) and Selective Catalytic Converter (SCC)  
Engine Torque Rating (ft.-lb.) 1750  
Engine Warranty 5 yr/250,000 mi  
Allison® World 4000 MH, 4th Generation  
6-Speed Automatic Transmission Warranty 5 yr/200,000 mi  
Allison® Hydraulic Transmission Retarder  
Cruise Control  
Pneumatic Drive Belt Tensioners  
Turbo-Boost Gauge  
Electric Starting Aid  
3-speed Engine Cooling Fan  
Engine Coolant Filter  
Block Heater  
Two-Step Dual Filter with Water Separator  
Prevost Liaison

## BRAKES (Chassis)

All Wheel Disc w/ABS  
Front Wheel Brake Boosters Type 27  
Drive Wheel Brake Boosters Type 24-24  
Tag Wheel Brake Boosters Type 14-16  
Parking Brake Booster on Tag Wheels

## ELECTRICAL SYSTEM (Chassis)

Fully Multiplexed Electrical System  
12v Exterior Lighting  
24v Main System  
Driver's A/C System with Quadruple Bosch 24V/120 AMP Alternator

## STEERING/SUSPENSION (Chassis)

Tilt and Telescopic Steering Wheel  
ZF Variable Assistance Power Steering System  
Independent Suspension System  
Front and Drive Axle Sway Bars  
Integrated Pneumatic Level - Low Leveling System  
Liftable Tag Axle  
Splash Guards Between Drive & Tag Axles and Behind Front Axle  
Rear End Ratio 4.10

## TIRES/WHEELS (Chassis)

Michelin® 315/80R22.5 (Drive Axle)  
Michelin® 365/70R22.5 (Front & Tag Axle)  
Aluminum Rims 22.5"x9" (Drive Axle)  
Aluminum Rims 22.5"x10.5" (Front & Tag Axle)

## INNOVATIVE SAFETY FEATURES

Prevost Electronic Stability Program (ESP)  
Prevost Aware Adaptive Cruise Braking (ACB)  
Automatic Fire Suppression System  
Beru Tire Pressure Monitoring System  
Xenon Low Beam Headlights

## CUSTOM EXTERIOR GRAPHICS & PAINT

Base Coat/Clear Coat Standox® Paint  
Custom Painted Graphics with Super Clear Coat

## EXTERIOR

(4) Roof Mounted Power Awnings with Motion Sensors  
Front and Rear Roof Cowlings  
Roof Mounted Air Horns  
Stainless Steel Rub Package  
Mud Flaps with Weights and Stainless Steel Trim  
Custom Fiberglass Fenders  
Manual Leveling System (PREVOST)  
Docking Lights  
Bay Areas are Capeted, Stainless Steel, or Acrylic  
Slide Out Trays in Storage Area  
Entrance Doorbell and Camera  
(4) Zip Dee® Chairs in Custom Built Storage  
Slide Out Grill

## DASH/ENTRY

Custom Upholstered Dash  
Illuminated Dash Panel  
Custom Interior Entry Door Panel  
Electric Privacy Shades for Driver and Passenger Windows  
Controls located at Driver and Passenger Area  
ISRI® Air Ride Driver Seat, Heated and 6-way Power  
Passenger Seat Heated and 6-way Power with Power Foot Rest  
Electric Step Well Cover, Switch at Driver and Passenger Area  
40 Channel Cobra® CB Radio  
12v Master Kill Switch  
220v Master Kill Switch  
Navigation System including:  
Color Backup Camera  
Side Mounted Cameras  
Bluetooth Technology  
XM/AM/FM/CD Player

## AUDIO-VISUAL

Blu-Ray DVD and Surround Sound in Salon/Bedroom/Entertainment Bay  
Electric TV Antenna  
(2) Winegard Mission Roadtrip In-Motion Satellite Systems w/HD DVR Receivers  
26" LG LED HD Television in Driver's Side Slide Out  
47" LG LED HD Lift-Up Television in Entrance  
52" LG LED HD Television on Lift in Passenger Side Slide Out  
47" LG LED HD Television in Bedroom  
32" LG LED HD Television in Entertainment Bay  
Crestron® System with 2 RF Remote Touch Screen Controls for:  
Audio/Visual in Salon/Bedroom/Entertainment Bay  
XM/AM/FM/CD Player  
Blu-Ray DVD Player

## INTERIOR LIGHTING

Halogen and LED Ceiling and Cabinet Down Lighting w/Variable Control  
Accent and Aisle Lighting Throughout Interior  
Custom Window Lighting Throughout Interior  
Reading Lights in Bedroom

## SALON/GALLEY

(1) Villa Custom "L" Sofa Sleeper, (1) Dinette  
Granite Countertops  
Granite and Tile Backsplashes  
Designer Kitchen Sink with Sink Cover and Custom Faucets  
Jenn-Air Side by Side Refrigerator  
Miele 2-Burner Cook Top Recessed with Cover  
Fisher & Paykel Dishwasher Drawer  
Jenn-Air Convection Oven  
Bosch Washer and Dryer  
Wardrobe  
Custom Wood Floors  
Custom Crown and Chair Rail Moldings  
Hutch  
U-Line Wine Chiller  
Brew Express Coffee Maker  
Air Operated Pocket Doors with Emergency Override  
Central Vacuum

## CEILING, WINDOWS, & WALL TREATMENTS

Automatic Shades with Custom Treatments on All Windows  
Suede Ceiling Material  
Suede Wall Material  
Designer Tile Backsplash in Kitchen  
Solid Surface Window Sills  
Designer Vanity Backsplashes in Bathroom  
Tile Walls in Bathroom

## AIR CONDITIONING & HEATING

Coleman Mach Low Profile 15,000 BTU Roof Air Conditioner with:  
Heat Pump and Dual Control Module  
(3) Coleman Mach Low Profile 13,500 BTU Roof Air Conditioner with:  
Heat Pump and Dual Control Module  
Webasto 50,000 BTU Diesel Fired Boiler Hydronics System  
Electric Heater for Plumbing Bay  
110v Electronic Heater in Step Well, Bathroom, and Kitchen Base  
(3) Interior Zones and (1) Utility Bay Zone  
(7) Heat Exchangers

## PLUMBING

154 Gallon Fresh Water Tank  
136 Gallon Total Holding Tanks  
68 Gallon Gray and Black Water Tanks  
Driver Side Automatic Electric Dump Valves for Gray and Black Tanks  
20 Gallon Electric Water Heater with Winterization System & Motor aide  
Water Pump with Accumulator Tank 65 PSI  
12v Back Up Water Pump  
Utility Bay:  
City Water Inlet  
Exterior Water Faucet  
Hot and Cold Faucet  
Water Manifold System  
Soap and Towel Dispensers  
Black Tank Rinse

## BEDROOM

Automatic Blackout Shades  
Quilted Bedspread with Designer Pillows  
Jr. King 66" x 77"  
Safe  
Wardrobe w/drawer  
(2) Nightstands  
Bench Seat

## BATHROOM

Custom Stainless Sinks and Faucets  
Custom Shower Walls with Seat and Shampoo Caddy  
Pressure Balanced Shower Valve with Slide Bar  
Bath Accessory Package  
Tecma Toilets  
Vent Fans  
Glass Shower Door

## ELECTRICAL

Charging and Power:  
40 AMP 24v Charger for Main Engine Batteries  
75 AMP 24v Alternator for Main Engine Batteries  
Generator Battery Boost/House/Chassis  
(2) Prevost Factory Install 270 AMP 24v Alternator for House Batteries  
50 AMP Automatic Power Transfer Between Generator & Shoreline Surge Guard  
with Generator Priority and Manual Override  
50 AMP Breaker Panel for Generator & Shoreline  
(4) 12v Deep Cycle 8D Outback Lifeline 290 AMP/hr Batteries  
(2) Inverters (7,000W or 7KW) will Operate:  
Front Air Conditioner  
Televisions/Entertainment System (Salon)  
110v AC Receptacles  
Convection Oven  
Refrigerator  
Power Management System with Monitors:  
DC Battery Voltage  
Holding Tank Levels  
Generator Operation (AGS)  
Auto Water Fill  
Coach Battery Voltage  
20KW Power Tech® Diesel Generator:  
Stainless Steel Exhaust  
Air Bag Suspension  
50 AMP to Twin 30 AMP Shore Power Adapter

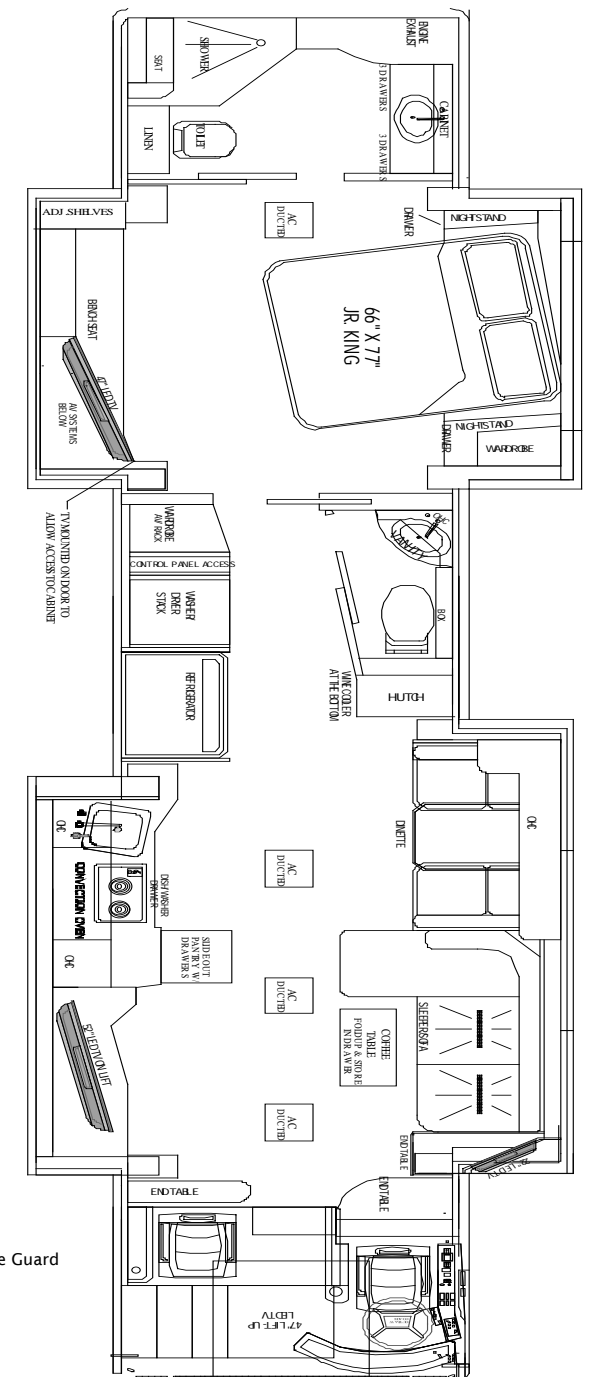

**MSRP: 2,097,800.00**

While every effort is made to assure this information to be accurate, variations in the manufacturing process and dealer installed accessories may cause this window sticker display to vary from that on the vehicle. Check with your dealer for complete information. Does not include Dealer installed options and accessories, local taxes or license fees.